

Hybrid and Electric Cars

Objectives

- Officers will have an appreciation of the hazards attached to hybrid and electric cars
- Officers will be aware of control procedures to reduce the risk from those hazards

How to recognise

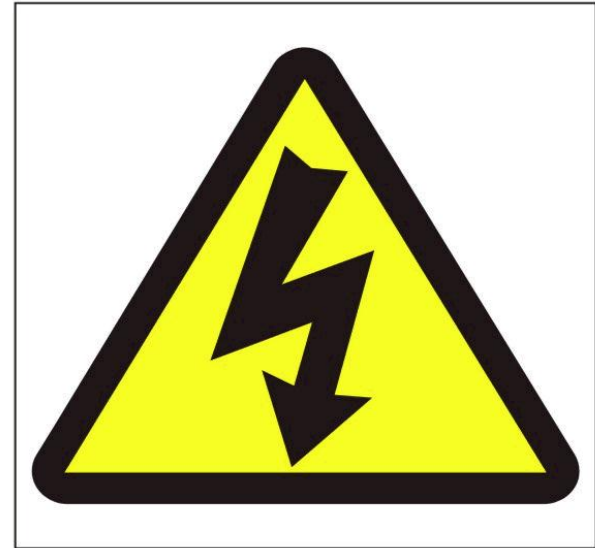

LEXUS
HYBRID
DRIVE

How to recognise



Do not cut orange cables

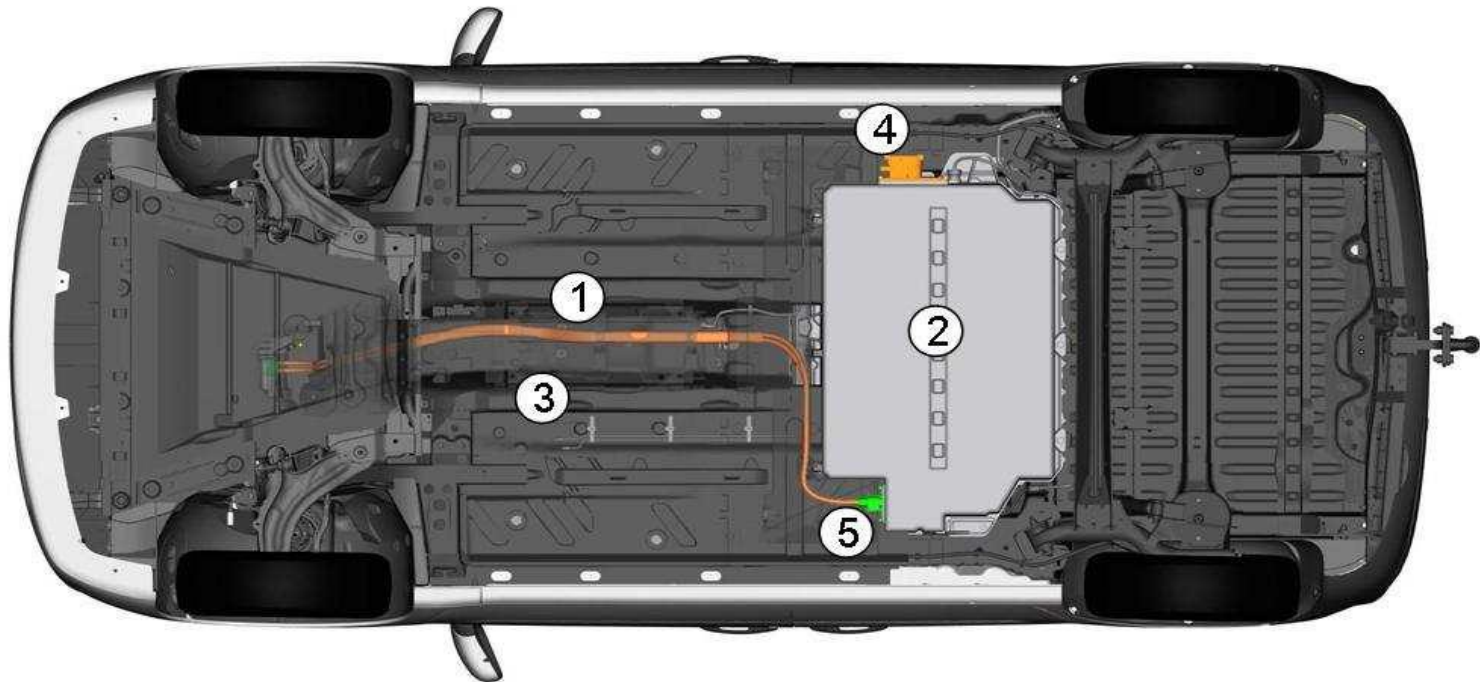

Do not cut the orange cables



Do not cut the orange cables



Electrical Hazard

- Potential electric shock
- Control measure 1 – switch the car off
- Control measure 2 – disconnect the lead acid battery
- Control measure 3 – remove service plug

Main Hazard

- The car may be live and capable of motion at any time.
- Control measure 1 – make sure car is switched off – no dashboard lights on.
- Control measure 2 – disconnect the lead/acid battery

READY



Emergency Action

- Wheels to be chocked
- Key switched off and removed – handed to crew commander
- Or
- Check dash – if ready lights show press power button once



Smart Key

Does not need to be in ignition for car to start

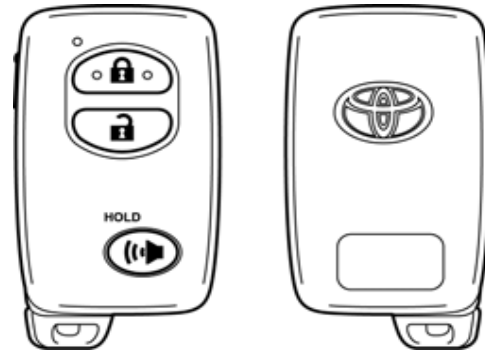

Remove from vehicle if possible

Emergency action

- If Key not available disconnect battery
- Engage hand brake
- Place in P – Park if automatic

Emergency Action

- Further Options
 - Disconnect battery
 - Remove service plug

Removing service Plug

- Extra safety
- Need to be familiar with type of vehicle
- Wear insulated gloves
- Wear face shield

Removal of service plug



Vehicle Fire

- Carbon Dioxide/Dry powder
- Battery fire – let it burn itself out
- BA must be worn

Summary

- Car can move while quiet
- Small battery controls big battery
- CO₂/Dry powder for fires

Questions

